

# Inground 1-11MH

Cat. No. IG111MH20

Cat. No. IG111MH35



The Inground 1-11MH has been designed to be installed as a flush-mount recessed uplighter and is ideal for use in concrete or stone materials. The luminaire can be driven over at 10km/h max (6mph), maximum vehicle weight 1500kg (3000lbs) or walked upon without damaging it. This luminaire also has a 'Flush Fit' lens which stops water pooling and depositing dirt on the lens.

Metal halide lamps are highly energy efficient light sources using less energy and out putting 2 - 3 times the light of a halogen lamp. Designed for use with MR16 GX10 20 or 35 watt lamps.

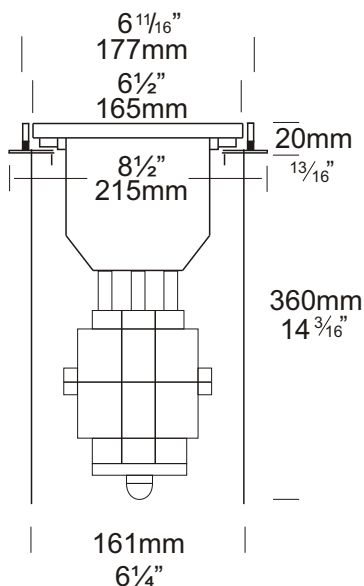

## Ordering Information

### Luminaire Type

IG111MH20 - Inground 1-11  
Metal Halide 20 watt  
IG111MH35 - Inground 1-11  
Metal Halide 35watt

### Flange Option

SBZ - Solid Bronze  
SS - 316 Stainless Steel

### Accessories

CJK150 - Cable Joint Kit  
LENSAR111F - Frosted Lens  
LENSSPREAD - Lineal Spread  
Lens

### Body

Black only

Ordering Example: IG111MH20 SS - Inground 1-11MH 20watt  
316 Stainless Steel flange  
LENSAR111F - Frosted Lens  
(Accessories ordered separately)

**HUNZA**™ PURE  
OUTDOOR  
LIGHTING

**HUNZA FACTORY**  
130 Felton Mathew Ave  
Glen Innes  
Auckland 1072  
New Zealand

Ph: 64-9-528 9471  
Fax: 64-9-528 9361  
hunza@hunza.co.nz  
www.hunza.co.nz

**INTERNATIONAL CONTACTS:**  
www.hunza.co.nz/contacts.php

Specifications may change without notice.  
Manufactured in New Zealand.

© 2009 Hunza Holdings Ltd.

Ver 1.4

## Luminaire Construction

### Body

Cast from virgin high corrosion resistant CC401 low copper aluminium alloy, with chromate substrate and high UV resistant black polyester powder coat.

### Flanges

The flange is attached to the body by four 316 stainless steel allen head anti vandal screws and is available in either

Solid Bronze - 170mm (6½") bar.

Solid 316 Stainless Steel - 170mm (6 ½") rod.

## Mounting

The Inground 1-11MH is supplied with a mounting canister for casting in concrete. The fitting can be driven over or walked upon without damaging it. Maximum drive over speed 10 km/h (6 mph) and maximum vehicle weight 1500kg (3300lbs).

## Features

### Lens:

12mm (½") thick 'Flush Fit' clear tempered shatter resistant glass.

### Life Time Warranty

### Gasket:

Silicone, iron impregnated 220°C (428°F).

### Lamp Holder:

GX10 - 350°C (662°F) ceramic multi contact lamp holder with 250°C (480°F) teflon cables.

### Accessories:

Cable Joint Kit (Cat. CJK150).

Lineal Spread Lens

(Cat. LENS.SPREAD).

Frosted Lens (Cat. LENS.AR111F).

## Standards

IP66 AS/NZS60598.2.2



UL1598

### Luminaire Weight

4.8kg (10lb 8oz)

### Power Supply

Ballast built in: 230 - 240 volt ac 50Hz.

### USA and Canada:

Ballast built in: 120 volt ac 60Hz.

Luminaire: supplied with MR16 GX10 20 or 35 watt lamp

CMH20W MR16 SP Candela Power Distribution

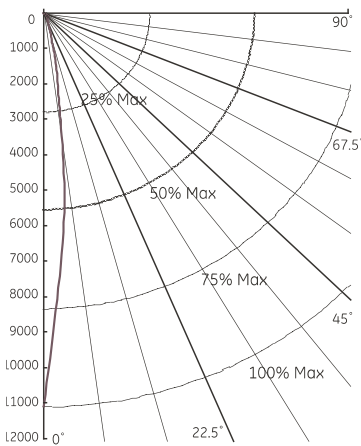

CMH20W MR16 FL Candela Power Distribution

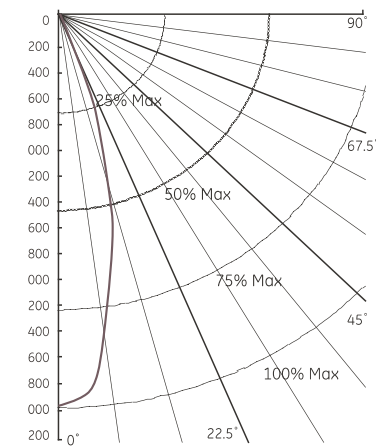

CMH20W MR16 WFL Candela Power Distribution

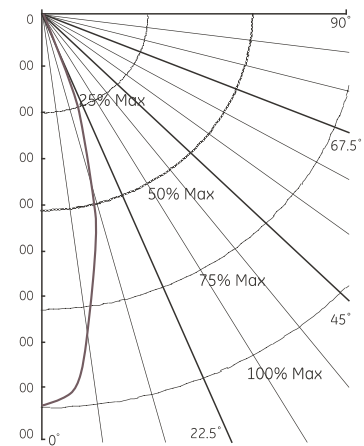

CMH 35 W/MR16/930/SP Candela Power Distribution

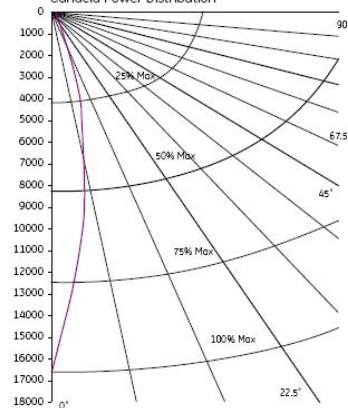

CMH 35 W/MR16/930/FL Candela Power Distribution

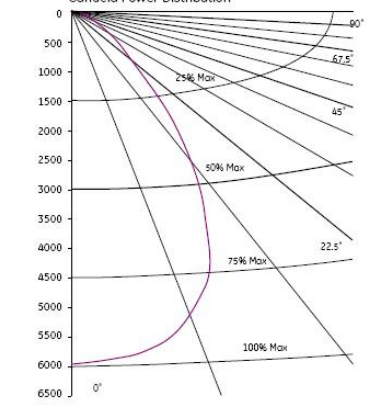

CMH 35 W/MR16/930/WFL Candela Power Distribution

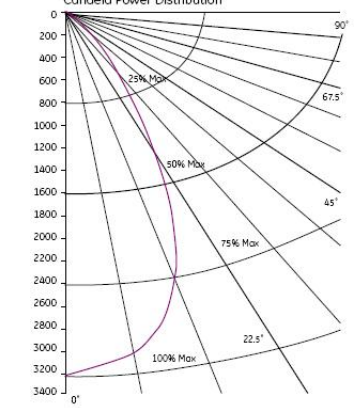

**HUNZA**™ PURE OUTDOOR LIGHTING

**HUNZA FACTORY**  
130 Felton Mathew Ave  
Glen Innes  
Auckland 1072  
New Zealand

Ph: 64-9-528 9471  
Fax: 64-9-528 9361  
hunza@hunza.co.nz  
www.hunza.co.nz

**INTERNATIONAL CONTACTS:**  
www.hunza.co.nz/contacts.php

Specifications may change without notice.  
Manufactured in New Zealand.  
© 2009 Hunza Holdings Ltd.

Ver 1.4