

# Lawn Lite

Cat. No. LL

[Click here for specifications on this luminaire](#)

[Return to main index](#)



The Lawn Lite is designed for insertion into a lawn or garden bed and can be mowed over without damaging the luminaire. Designed so the lamp can be directed up to 20 degrees at a bush, tree, or the outside of a building, etc. without the need to remove the luminaire from the ground due to the vandal-resistant three stainless steel allen head screw fixing system which attaches the flange to the body of the luminaire. With a 'Flush Fit' lens to stop water pooling and depositing dirt on the lens.

## Ordering Information

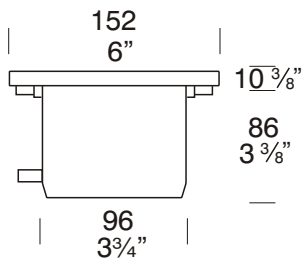

Luminaire Type	Flange Option	Body	Accessories
LL - Lawn Lite	BZ - Bronze BK - Black GN- Green MS- Metallic Silver	Luminaires with a Stainless Steel or Bronze flange have a black body, otherwise body is the same as flange colour.	CJK150 - Cable Joint Kit HCR - Hex Cell Louver LLFL - Frosted Lens
	BZ - Bronze (Solid) SS - 316 Stainless Steel		

Ordering Example LL GN - Lawn Lite Green, Flange Body Green

LLFL - Frosted Lens  
*(Accessories ordered separately)*



**FACTORY:** Ph: 64-9-528 9471 Fax: 64-9-528 9361.

**USA:** Ph. 310 560 7310 Fax. 1 877 692 4589.

hunza@hunza.co.nz www.hunza.co.nz

Specifications may change without notice.

130 Felton Mathew Ave, Glen Innes, Auckland, New Zealand.

3237 Long Island St, W. Sacramento, California 95691, USA.

Manufactured in New Zealand.

© 2004 Hunza Holdings Ltd

Ver 1.2

## Luminaire Construction

### Body:

Cast from virgin high corrosion resistant CC401 low copper aluminium alloy, with chromate substrate and high UV resistant polyester powder coat -

**Colours:** Black, Bronze, Green, Metallic Silver.

### Flanges:

The flange is attached to the body by three 316 stainless steel allen head anti vandal screws and is available in either -

Powder coated, cast aluminium or CNC machined from one of the following metals:

Solid bronze -150mm (6") bar.

Solid 316 Stainless Steel - 150mm (6") rod.

## Mounting

Suitable for insertion into a lawn or gardens etc. Mounted level with ground surface, seated on its base.

## Features

### Lens:

12mm (½") 'Flush Fit' clear tempered shatter resistant glass.

Life Time Warranty.

### Gasket:

Nytrol 220c (428<sup>o</sup>f).

### Lamp Holder:

GU5.3 350<sup>o</sup>c (662<sup>o</sup>f) ceramic multi contact lamp holder with 250<sup>o</sup>c (480<sup>o</sup>f) teflon cables. Lamp holder can be rotated 360<sup>o</sup> and angled up to 20<sup>o</sup>.

### Accessories:

Cable Joint Kit (Cat. CJK150).  
Not approved for USA / Canada.

Frosted Lens (Cat. LLFL).

Hex Cell Louver (Cat. HCR)

## Standards

IP66



UL1838

## Luminaire Weight

LL .94kg (2lbs 1oz)

LLBZ 1.14kg (2lbs 8oz)

LLSS 1.13kg (2lbs 7oz)

## Power Supply

HUNZA<sup>®</sup> Inground or Wall Mount  
Transformer: not included.

### USA and Canada:

HUNZA<sup>®</sup> Wall Mount Transformer:  
not included.

## Luminaire: supplied with

MR16 GU5.3 20, 35 or 50 watt  
lamp max.

### USA and Canada:

MR16 GU5.3 20 watt lamp max.

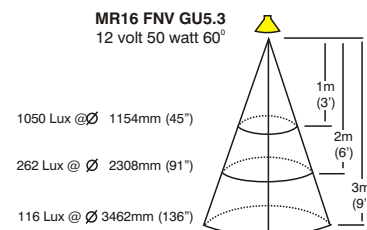
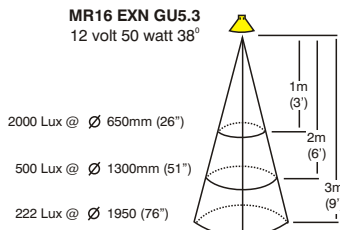
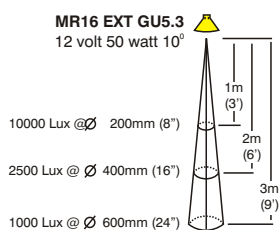
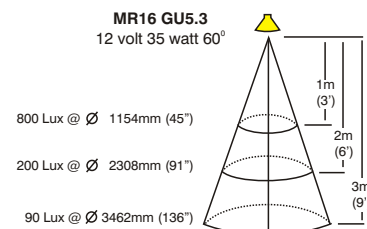
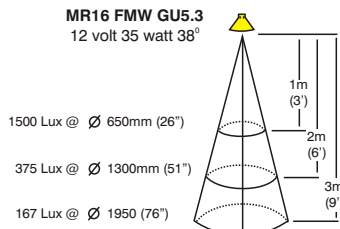
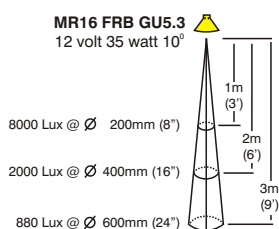
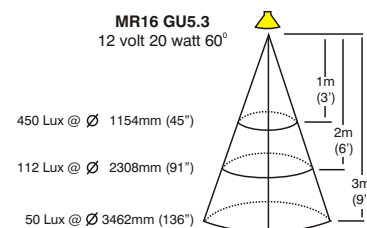
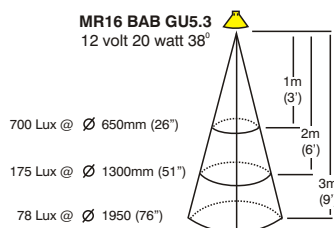
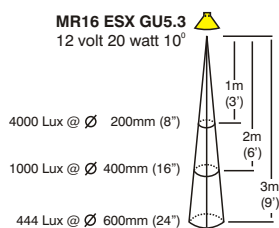

**FACTORY:** Ph: 64-9-528 9471 Fax: 64-9-528 9361.

**USA:** Ph. 310 560 7310 Fax. 1 877 692 4589.

hunza@hunza.co.nz www.hunza.co.nz

Specifications may change without notice.

130 Felton Mathew Ave, Glen Innes, Auckland, New Zealand.

3237 Long Island St, W. Sacramento, California 95691, USA.

Manufactured in New Zealand.

© 2004 Hunza Holdings Ltd

Ver 1.2