

Step Lite Square

Cat. No. SLsq
 Cat. No. SLflsq
 Cat. No. SLsqLED



Step Lite is designed with a 88mm x 88mm (3½" x 3½") flange for flush mounting into masonry, stone or wood. For illumination of steps and ground level horizontal lighting, for example, across driveways or exterior paved areas. When a canister is used there are no mounting holes in the flange.

A 240 volt 5 watt fluorescent option is available which offers excellent light output, low energy usage and very low heat generation, this changes the luminaire to an IP66 rating .

Ordering Information

Luminaire Type

SLsq - Step Lite Square

Material/Finish

BK - Black
 BZ - Bronze
 GN - Green
 MS - Metallic Silver
 WH - White

 CP - Copper
 SS - 316 Stainless

Accessories

CJK150 - Cable Joint Kit
 DFL - Frosted Lens
 FL - Fluorescent Option
 HCL - Hex Cell Louvre Adaptor
 LED - LED Array
 D/LED - LED Driver
 Canss - 316 Stainless Steel Canister
 Flucan - Fluorescent Canister
 Scan - Step Lite Canister

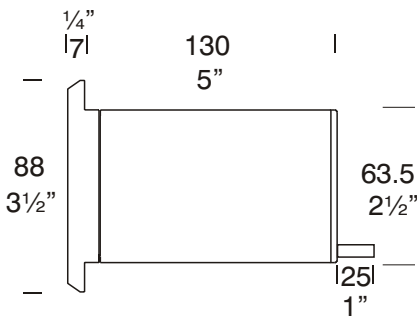
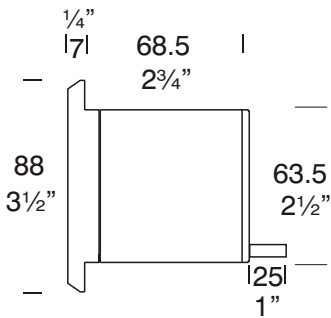

Fluorescent Option



Ordering Example: SLsq BZ - Step Lite Square in bronze powder coat.

SLflsq SS - Step Lite Square with Fluorescent Option in 316 Stainless Steel

HCL BK - Hex Cell Louvre Adaptor in black.

(Accessories ordered separately)

Patent Pending



FACTORY: Ph: 64-9-528 9471 Fax: 64-9-528 9361.

USA: Ph. 310 560 7310 Fax. 1 877 692 4589.

hunza@hunza.co.nz www.hunza.co.nz

Specifications may change without notice.

130 Felton Mathew Ave, Glen Innes, Auckland, New Zealand.

3237 Long Island St, W. Sacramento, California 95691, USA.

Manufactured in New Zealand.

Ver 1.2

© 2004 Hunza Holdings Ltd

Luminaire Construction

CNC machined from one of the following metals:

High corrosion resistant 63.5mm (2½") x 10mm (25/64") aluminium.
End cap - solid aluminium 63.5mm (2½") rod, flange 90mm x 90mm (3½" x 3½") solid aluminium bar with chromate substrate and high UV resistant polyester powder coat -

Colours Black, Bronze, Green, Metallic Silver, White.

Copper: 63.5mm (2½") x 10.5mm (13/32"). End cap - solid copper 63.5mm (2½") rod.

Flange 90mm x 90mm (3½" x 3½") solid copper bar.

316 Stainless steel: 9mm (11/32"). End cap - solid 316 stainless steel 63.5mm (2½") bar.

Flange 90mm x 90mm (3½" x 3½") solid 316 stainless steel bar.

Mounting

Designed to fit through a 66mm (2 5/8") hole and be fixed into position by two screws in the flange or a Step Lite canister (see accessories) can be used which maintains the aesthetic look of the flange by eliminating the two screw holes in the flange.

Features

Lens:

3mm (1/8") thick clear tempered shatter resistant glass.
Life Time Warranty.

Gaskets:

Silicone, iron impregnated 220°C (428°F).

Lamp Holders:

GU5.3 - 350°C (662°F) ceramic multi contact lamp holder with 250°C (480°F) teflon cables.

Fluorescent

E27 PET 210° (410°F) base mount.

Accessories:

Cable Joint Kit (Cat. CJK 50)
Not approved for USA /Canada.

Fluorescent Option 5 watt 240 volt (Cat. FL) IP66.

Frosted Lens (Cat. DFL).

Hex Cell Louvre Adaptor (Cat. HCL).

LED Array Red, Blue, White, Yellow, Green (Cat. LED). Refer sheet 8.4

LED Driver (Cat. D/LED) Refer sheet no. 8.4

Step Canister (Cat. Slcan).

Fluorescent Canister, PVC (Cat. Flucan).

316 Stainless Canister for use in lime stone etc. (Cat. Canss).

Standards

IP66 / IP68



UL 1838

Luminaire Weight

12 volt
Alum .465kg (1lb)
Cop 1.340kg (2lb 15oz)
SS 1.055kg (2lb 5oz)

Fluorescent IP66
Alum .780kg (1lb 11oz)
Cop 2.275kg (5lb)
SS 1.690kg (3lb 11oz)

Power Supply

HUNZA® Inground or Wall Mount
Transformer: not included.

LED - Refer sheet no. 8.4

USA and Canada:

HUNZA® Wall Mount Transformer:
not included.

LED - Refer sheet no. 8.4

Luminaire: supplied with

Halogen

MR16 GU5.3 20 watt lamp max.

Fluorescent

E27 - 240 volt 5 watt self ballasted lamp.

LED

LED - Refer sheet no. 8.4

USA and Canada:

MR16 GU5.3 20 watt lamp max.

LED

LED - Refer sheet no. 8.4

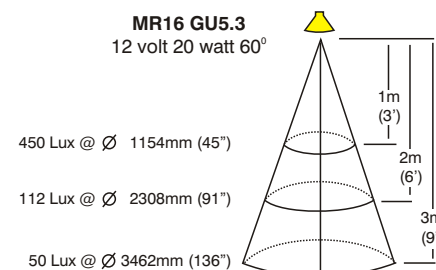
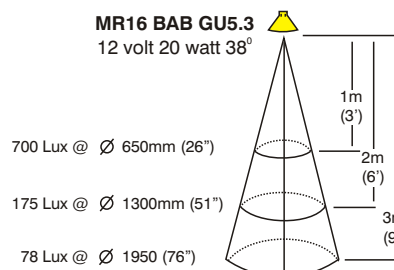
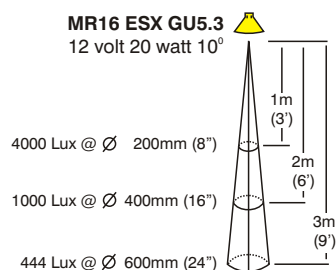

FACTORY: Ph: 64-9-528 9471 Fax: 64-9-528 9361.

USA: Ph. 310 560 7310 Fax. 1 877 692 4589.

hunza@hunza.co.nz www.hunza.co.nz

Specifications may change without notice.

130 Felton Mathew Ave, Glen Innes, Auckland, New Zealand.

3237 Long Island St, W. Sacramento, California 95691, USA.

Manufactured in New Zealand.

© 2004 Hunza Holdings Ltd

Ver 1.2