

Wall Down Lite

Cat. No. DL
 Cat. No. DL/LED
 Cat. No. DL/R

[Click here for specifications on this luminaire](#)

[Return to main index](#)

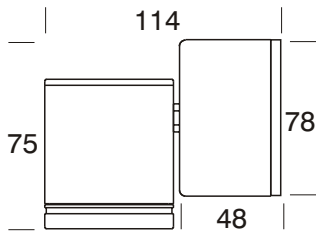
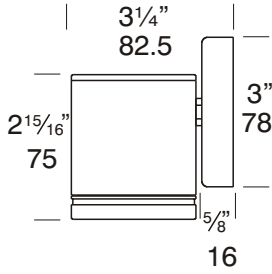

Retro™

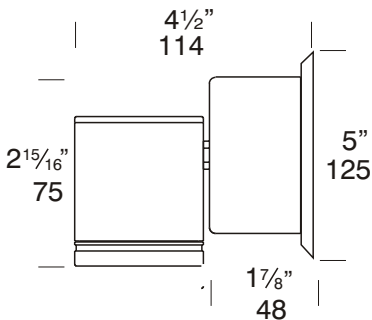

Retro™
 USA/Canada

Suitable for mounting on timber, masonry, stone, etc. Non adjustable for one way wall washing, can be mounted with the lamp directed up or down. Water resistant with a 78mm diameter mounting base, complete with stainless steel screws.

The Retro™ is a 110/240-12 ac mains option suited to an installation where mounting a transformer is a problem, e.g. a brick wall where there is only the cable protruding out of the wall and it is not an option to recess the transformer or when replacing an existing light fitting. The base size increases in size to accommodate the encapsulated IP66 dimmable transformer.

Ordering Information

Luminaire Type

DL- Wall Down Lite

Material/Finish

- BK - Black
- BZ - Bronze
- GN - Green
- MS - Metallic Silver
- WH - White
- COP - Copper
- SS - 316 Stainless Steel

Accessories

- CJK150- Cable Joint Kit
- DFL- Frosted Lens
- GG- Glare Guard
- HCL- Hex Cell Louvre Adaptor
- LED- LED Array
- D/LED- LED Driver
- /R- Retro™ Transformer
 110/240-12 volt
- WBAP- Wall Box Adaptor Plate

Ordering Example

DL BK - Down Lite in Black
 DL/R SS - Down Lite Retro™ in 316 Stainless Steel

DFL - Frosted Lens

(Accessories ordered separately)



Patent Pending



FACTORY: Ph: 64-9-528 9471 Fax: 64-9-528 9361.
USA: Ph. 310 560 7310 Fax. 1 877 692 4589.
 hunza@hunza.co.nz www.hunza.co.nz
 Specifications may change without notice.

130 Felton Mathew Ave, Glen Innes, Auckland, New Zealand.
 3237 Long Island St, W. Sacramento, California 95691, USA.
 Manufactured in New Zealand.

Ver 1.2

© 2004 Hunza Holdings Ltd

Luminaire Construction

CNC machined from the following metals:

Body: High corrosion resistant low copper 63.5mm (2½") x 10mm (25/64") aluminium. End cap - solid aluminium 63.5mm (2½") rod,.

Base & Mounting Plate (Retro™): Cast from virgin high corrosion resistant CC401 low copper aluminium alloy chromate substrate and high UV resistant polyester powder coat - Black, Bronze, Green, Metallic Silver, White.

Body: Copper 63.5mm (2½") x 10mm (25/64). End cap - solid copper 63.5mm (2½") rod.

Base: Copper Hand spun 2mm (5/64")

Mounting Plate: Forged brass (Retro™)

Body: Stainless steel 316 63.5mm (2½") x 10mm (25/64) rod. End cap - 316 stainless steel 63.5mm (2½") rod.

Base: Investment cast and CNC machined (Retro™).

Mounting Plate: Investment cast and CNC machined.

Mounting

12 volt: the luminaire is mounted to the wall using two 316 stainless screws through a shallow base 16mm (5/8") in depth. A Wall Box Adaptor Plate (Cat. WBAP) is available as an accessory to fit 3.0 and 4.0 junction boxes for USA /Canada.

Retro™ 110/240-12 volt: a mounting plate is fixed to the wall using two screws, the luminaire is fitted to the mounting plate.

Features

Lens:

3mm (1/8") thick clear tempered shatter resistant glass.

Life Time Warranty.

Gasket:

Silicone, iron impregnated 220°C (428°F).

Lamp Holder:

GU5.3 - 350°C (662°F) ceramic multi contact lamp holder with 250°C (480°F) teflon cables.

Accessories:

CJK150 Cable Joint Kit (Cat. CJK150) Not approved for USA/Canada.

Frosted Lens (Cat. DFL).

Glare Guard (Cat. GG.)

Hex Cell Louvre Adaptor (Cat. HCL)

CJK150 cable Joint Kit (Cat. CJK150) Not approved for USA/Canada.

LED Array Red, Blue, White, Yellow, Green (Cat. LED). Refer sheet 8.4

LED Driver (Cat. D/LED) Refer sheet no. 8.4

Retro™ transformer 110/240-12 volt (Cat. /R)

Wall Box Adaptor Plate (Cat. WBAP) 12 volt luminaire USA / Canada)

Standards

IP66  UL1838

Luminaire Weight

12 volt: Alum .460kg (1lb)
Cop 1.200kg (2lb 10oz)
SS 1.080kg (2lb 6oz)
Retro: Alum .780kg (1lb 11oz)
Cop 1.680kg (3lb 11oz)
SS 1.505kg (3lb 5oz)

Power Supply

HUNZA® Inground or Wall Mount Transformer: not included.

LED -Refer sheet no. 8.4

USA/ Canada

HUNZA® Wall Mount: not included
Approved for internal use.

LED - Refer sheet no. 8.4

RETRO™

HUNZA® 110/240-12 volt ac silicone encapsulated electronic transformer built into the Retro™ base. Dimmable with a suitable dimmer.

Approved for internal use.

* Note see page 7.4 for details.

LED - Refer sheet no. 8.4

Luminaire: supplied with

MR16 GU5.3 20, 35 or 50 watt lamp
max.LED - Refer sheet no. 8.4
USA and Canada
MR16 GU5.3 20 or 35 watt lamp.LED -
Refer sheet no. 8.4

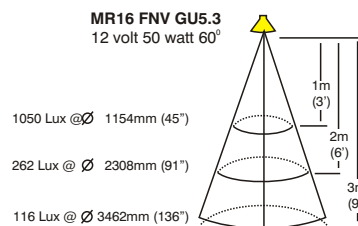
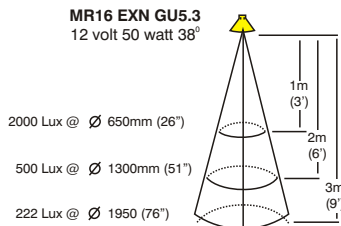
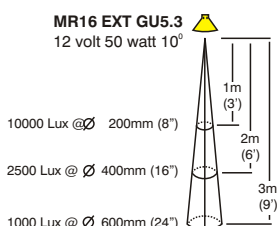
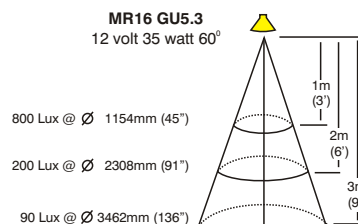
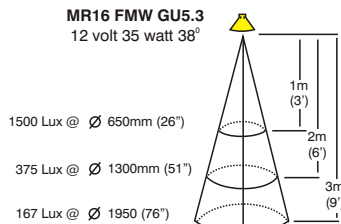
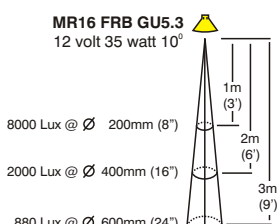
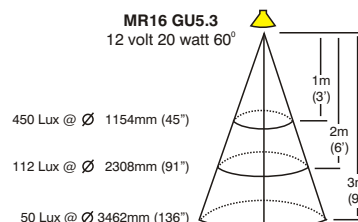
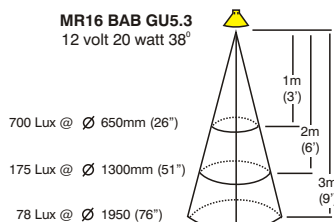
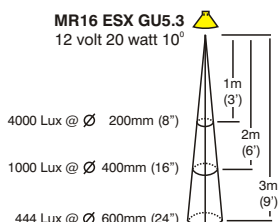

FACTORY: Ph: 64-9-528 9471 Fax: 64-9-528 9361.

USA: Ph. 310 560 7310 Fax. 1 877 692 4589.

hunza@hunza.co.nz www.hunza.co.nz

Specifications may change without notice.

130 Felton Mathew Ave, Glen Innes, Auckland, New Zealand.

3237 Long Island St, W. Sacramento, California 95691, USA.

Manufactured in New Zealand.

Ver 1.2

© 2004 Hunza Holdings Ltd